

CT33-12

12V 33Ah Lead Acid Battery

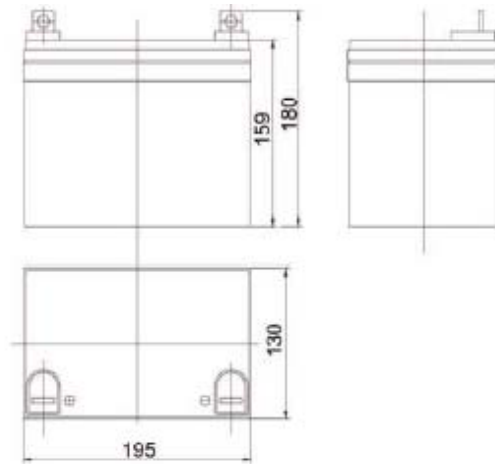

General Specifications and Characteristics

Battery model	CT33-12			
Nominal voltage	12V			
Capacity (25°C)	20hR(1.65A, 1.75v)	10hR(3.15A, 1.75v)	5hR(5.5A, 1.75v)	1hR(20.6A, 1.80v)
	33Ah	31.5Ah	27.5Ah	20.6Ah
Dimensions Max.	Length	Width	Height	Total Height
	195mm(7.68inch)	130mm(5.12inch)	159mm(6.26inch)	180mm(7.09inch)
Approx. Weight	10.2kg(22.5lbs.)			
Internal resistance	Fullchargedat25°C:14mΩ			
Self discharge	3% of capacity declined per month at 20°C			
Capacity affected by temp.(20 hR)	40°C	25°C	0°C	-15°C
	102%	100%	85%	65%
Charge voltage (25°C)	Cycle use		Float use	
	14.4-14.7V(-30mV/°C),max.current:9.9A		13.6-13.8V(-20mV/°C)	

